

CNC finish, wait for EDM machine.

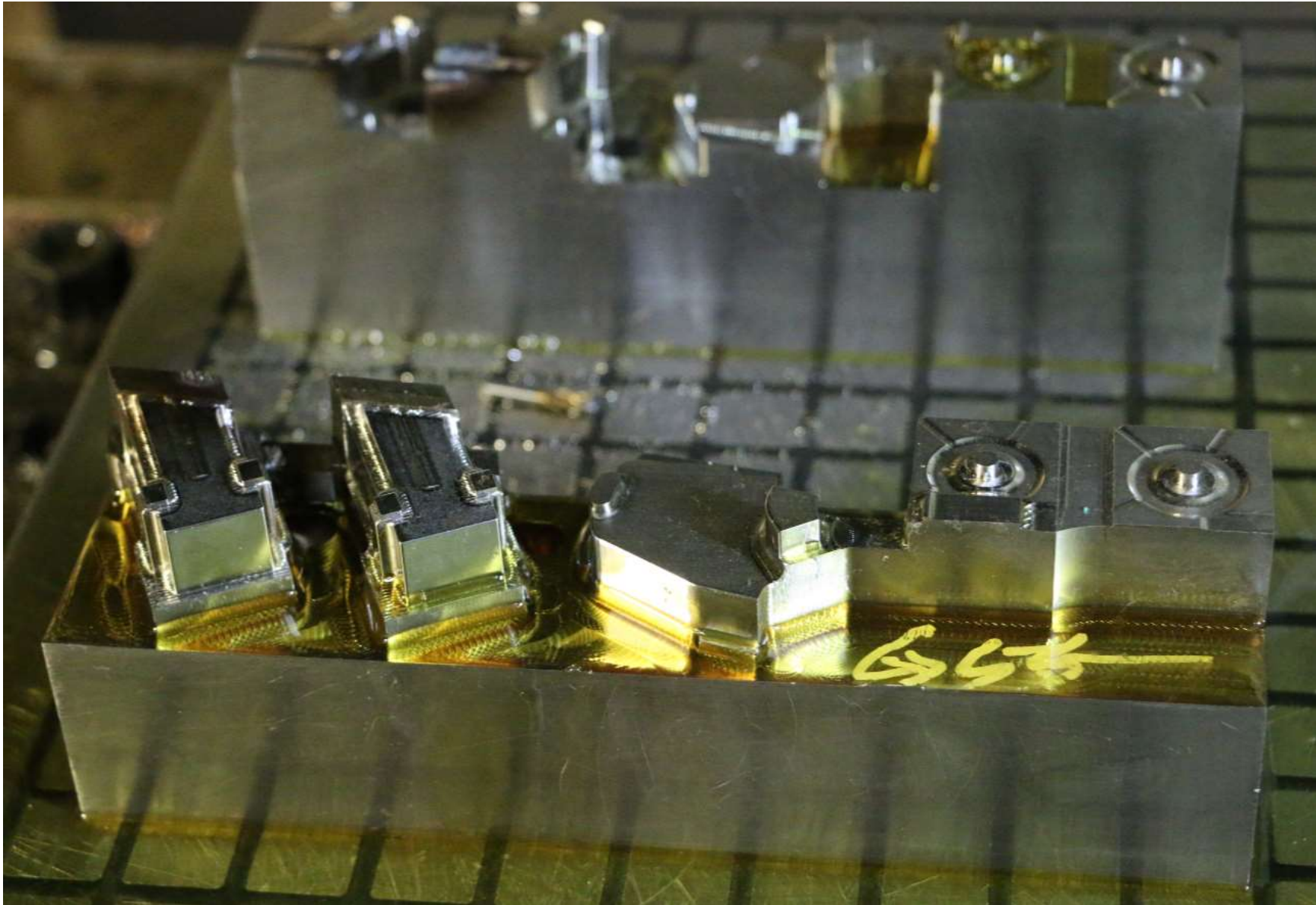

CNC machining.



EDM machining.

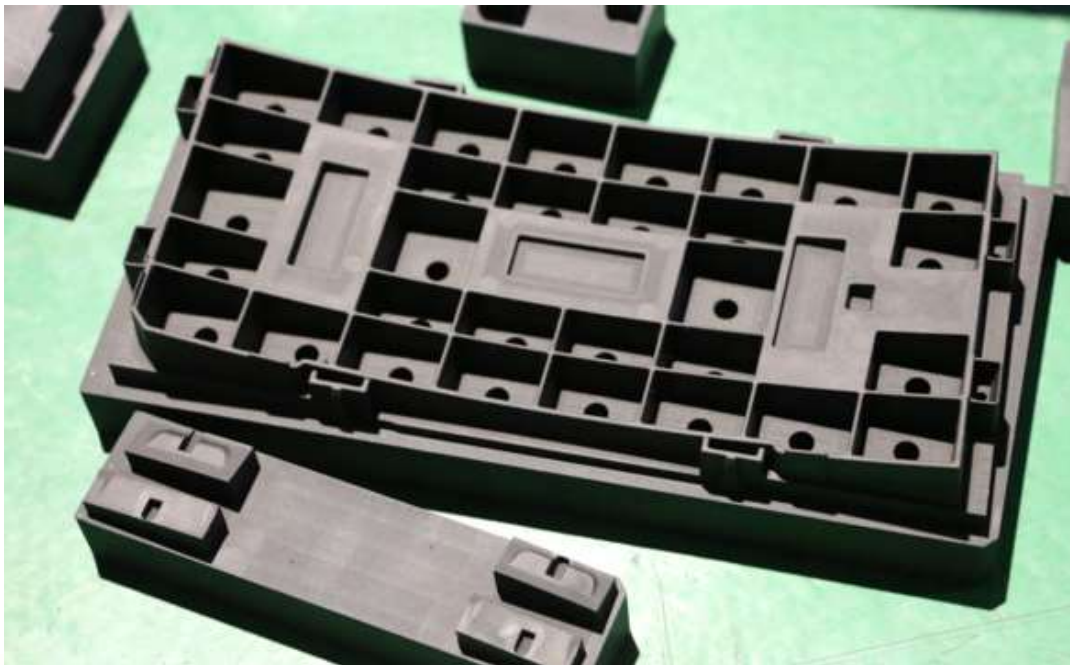
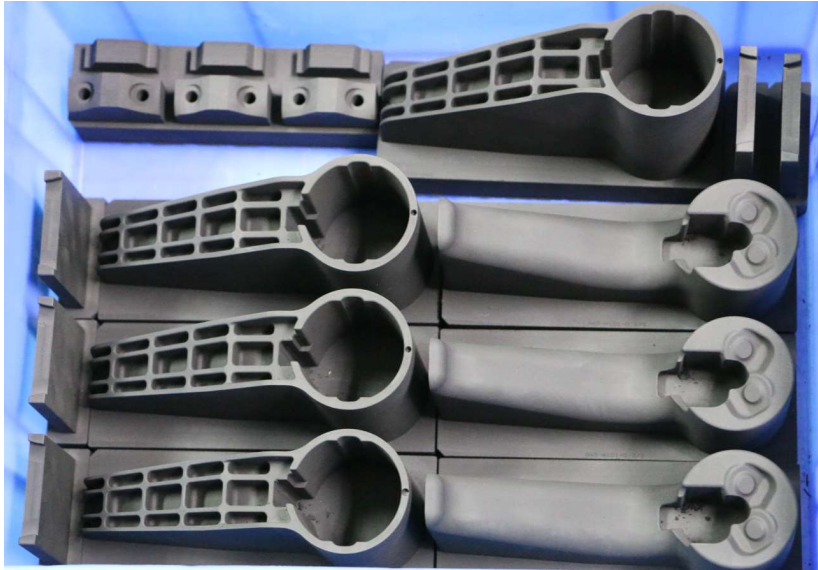

Most of them use graphite electrode processing, Processing efficiency is much higher than the ordinary copper, which help to guarantee the lead time.

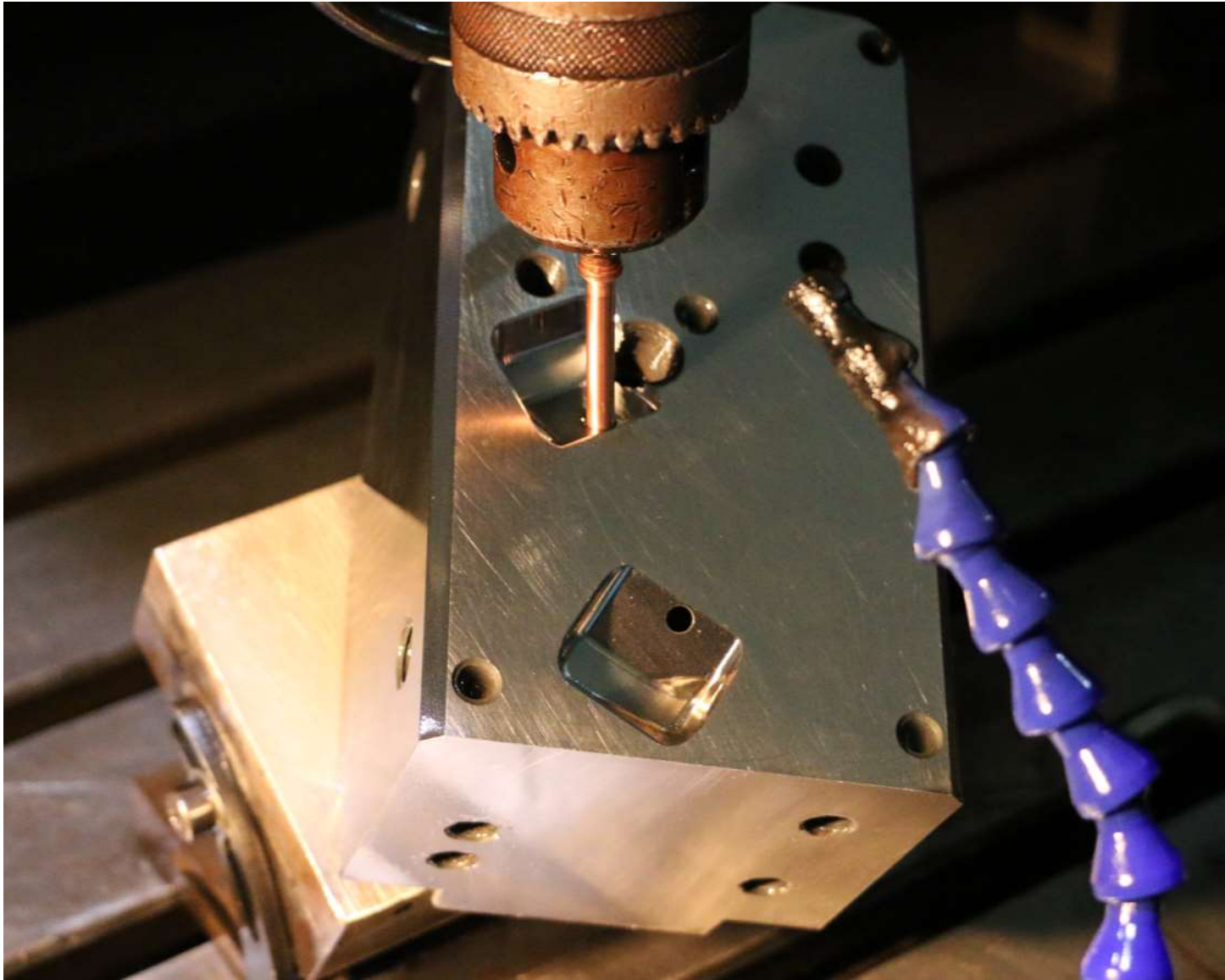

EDM machining.

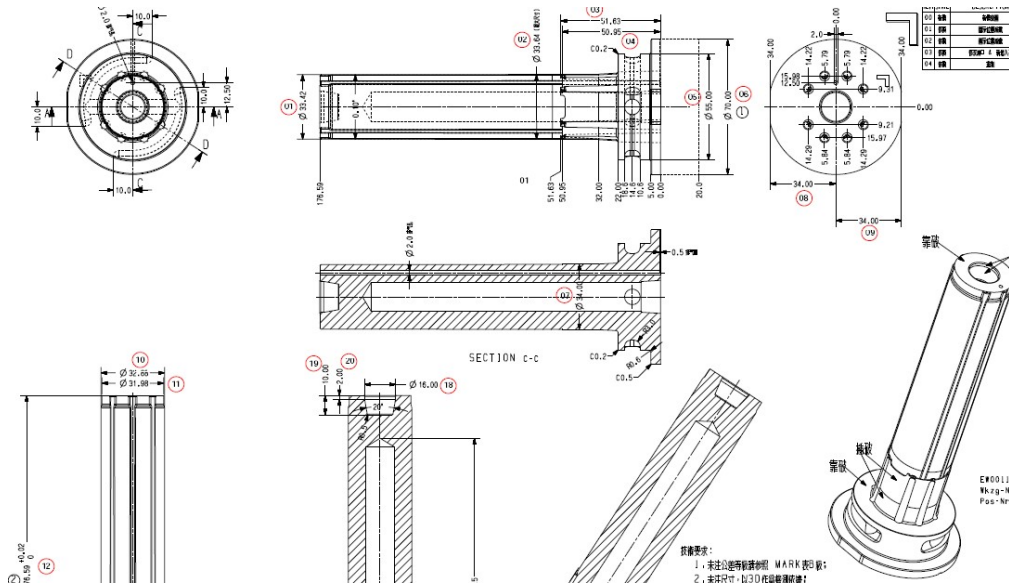

Mold No.:		TSD1702.70		Product Name:		DATE-MEASURING:									
Drawing No.:				MEASURING TEMPERATURE & RELATIVE HUMIDITY		℃ 24-Apr-17									
Date-Testing:				%		Color:									
ITEM No.	Dimension	Tolerance		Instruments	Actual Dimension								Judgement		
		MAX	MIN		CAV1	CAV2	CAV3	CAV4	CAV5	CAV6	CAV7	CAV8	OK	NG	
Weight(g):															
1	33.420	0.000	0.010	CP	33.410	33.410	33.420	33.410							
2	33.640	0.000	0.020	CP	33.620	33.620	33.630	33.620							
3	51.630	0.050	0.050	CP	51.660	51.670	51.660	51.680							
4	50.950	0.050	0.050	CP	50.980	50.980	50.990	50.970							
5	55.000	0.000	0.010	CP	54.990	54.990	54.990	54.990							
6	70.000	0.000	0.010	CP	69.990	69.990	69.990	69.990							
7	34.000	0.000	0.010	CP	33.990	33.990	33.990	33.990							
8	34.000	0.000	0.010	CP	33.990	33.990	33.990	33.990							
9	34.000	0.000	0.010	CP	33.990	33.990	33.990	33.990							
10	32.880	0.050	0.050	CP	32.910	32.920	32.910	32.920							
11	31.980	0.050	0.050	CP	32.020	32.010	32.030	32.020							
12	176.590	0.020	0.000	CP	176.600	176.600	176.600	176.600							
13	32.940	0.050	0.050	CP	32.980	32.970	32.980	32.970							
14	22.000	0.000	0.010	CP	21.990	22.000	21.990	22.000							
15	5.000	0.000	0.010	CP	4.990	4.990	4.990	4.990							

Before shipping, the dimension report can be provided to ensure the dimensions are within the tolerance.



热 处 理 质 量 报 告
HEAT TREATMENT QUALITY REPORT

报告编号 REPORT NO.	HT2013071800009-1			日期 DATE	18/7/2013			
客户名称 CUSTOMER	TSD Mold Industrial Limited			工作单号 ORDER NO.	E043-107648			
钢 种 GRADE	来料状态 DELIVERY CONDITION		数量 QTY	重量 TOTAL WGT	技术要求 TECHNICAL REQUIREMENT			硬度要求 HARDNESS REQUIREMENT
	退火 ANNEALED	预硬(注明硬度) HARDENED			淬火/回火 HARDENING	退火 ANNEALING	氮化 NITRIDING	
处理工艺 PROCESS	淬火 HARDENING		第一次回火 1 ST TEMPERING	第二次回火 2 ND TEMPERING	第三次回火 3 RD TEMPERING	其它 OTHER H. T. PROCESSES		
检验结果 TEST RESULT	板号(若适用)NO.	钢种 GRADE	规格 DIMENSION	数量 QTY	重量 TOTAL WGT	硬度 HARDNESS	备注 REMARKS	
	1	LKM2344 SUPER	37X130X250	1	8.4	HRC50.5		
	2	LKM2344 SUPER	40X130X250	1	9.7	HRC50.5		

检验/QC: 审核/CHIEF: E41 伍有智 FC-03-013-01



客户名称 Customer : TSD Mold Industrial Limited
 店铺 Sales Office : 河源龙记金属制品有限公司长安沙头分公司
 订单编号 Batch LKM_ID : ATEFPBCD
 认证日期 Date : 09/07/2013
 件数 Number Of Items : 2
 采购单号 PO Number : HJ-P01307090173
 模具编号 Mould Reference : TSD36.09-1-4
 页数 Page Number : 1/1
 网上认证地址 Online Verification : www.lkm.com.cn/cert.php

产品供应证书

Product Supply Certificate

本证书仅证明所列产品乃由龙记集团供应, 证书编号(LKM_ID)明如下:
 The above LKM_ID refers to a supply of the following item(s) by Lung Kee Group:

序号 Item Number	产品类型 Product Type	材料名称 Steel Grade	硬度 Hardness	比较标准 Comparable Standard	尺寸 Dimensions(mm)	产品编号 Product LKM_ID
1	锣磨	LKM2344 Super	Annealed to HB 225 max	AISI H13, Microdized +ESR	40.6*130.5*250.5	U7JS42LQ
2	锣磨	LKM2344 Super	Annealed to HB 225 max	AISI H13, Microdized +ESR	37.5*130.5*250.5	8MKA2BWY

材料名称 Steel Grade	合金成分 (只供参考用, %) Chemical Contents (For Reference Only, %)					
	C	Cr	Mn	Mo	Si	V
LKM2344 Super	0.38	5	0.4	1.3	1	1

以下空白

WERKSZEUGNIS
TEST REPORT
RELEVÉ DE CONTROLE
EN 10204-2.2

ISO 9001:2008 certification
EN ISO 14001:2004 certification



Cert. No.: 201182 / M1 / C73 / 2016.11.21
Blatt/Sheet/Page: 1 / 1

Besteller/Purchaser/Client: BÖHLER Special Steels (Shanghai) Co. Ltd. No. 335, Zhoujiabang Road Dongjing, Songjiang District 201619 SHANGHAI CHINA		Empfänger/Consignee/Destinaire: BÖHLER Special Steels (Shanghai) Co. Ltd. No. 335, Zhoujiabang Road Dongjing, Songjiang District 201619 SHANGHAI CHINA							
Bestell-Nr./Purchase order No./No. de commande: 2580001420 / 2016.07.26		Empfängerref.-Nr./Receiver reference No./Référence destinataire: -							
Werksauftrags-Nr./Works order No./No. de la commande de l'usine: 4310259349 / -		Lieferschein-Nr./Delivery note No./Avis de livraison du client: 51352205 / 2016.09.28							
Prüfgegenstand/Object of test/Object of exam: BÖHLER W360 ISOBLOC mother size or sawn, annealed max. 205 HB, ALLPLAN		Anforderungen/Requirements/Exigence: According to Order.							
Umfang der Lieferung/Volume of delivery/Star descriptive									
Pos./Loc. Dimensions Diamètre	Abmessung Length Longueur	Stückzahl No. of Pieces No. de Pièces	Schmelz-Nr. Heat No. No. de soude						
10/1	FL 603 x 303 mm	2000-5000 mm 1	5105,0 N4EW 1539213-2 B56818						
Chemische Zusammensetzung/Chemical Composition/Composition chimique (%)									
Schmelzanalyse/Chemical Composition Erschmelzung/Steelmaking Process/Arrière-Procédé			Schmelz-Nr. Heat No. No. de soude						
C	Si	Mn	P	S	Cr	Mo	Ni	V	
0,49	0,22	0,24	<0,0050	<0,0003	4,38	2,95	0,09	0,59	B56818
Mechanische Eigenschaften/Mechanical Properties/Caractéristiques mécaniques									
Pos./Loc.	Form / Zugbezug Forme / Réf. de l'essai Diamètre - Référence de l'essai	Profil Type No. Éprouvette							
10/1	157 - 175 HBW		1539213-2						
<div style="border: 2px solid red; padding: 5px; text-align: center;"> 证明由“博乐特殊钢(上海)有限公司深圳分公司”出售给 “TSD Mold Industrial Limited”的 W360 钢材, 合同号为 2510038670 35.5 x 90.5 x 110.5 mm 1PC 特此证明! 复印无效! 博乐特殊钢(上海)有限公司深圳分公司 </div>									
Radioaktivitätskontrolle/Radioactivity inspection: Ce-60<0,1Bq/g Hiermit kleiner als Grenzwert in der anzuwendenden Spezifikation (IAEA RS-G-1.7 für unbedenkliche Stoffe, therefore smaller than upper limit required according to specification IAEA RS-G-1.7 for innocuous material. Wir bestätigen hiermit, dass die oben genannte Produktion in Übereinstimmung mit den Best.-Vorgaben erfolgt. We hereby certify that a above mentioned production is in accordance with the exact needs of the customer. Nous certifions par la présente que la production sus-mentionnée est conforme aux exigences de la commande.									
BÖHLER Edelstahl GmbH & Co KG Mariazellerstrasse 25 8605 Kapfenberg, AUSTRIA www.boehler-edelstahl.com REGISTRIERTES GERICHT LANDESGERICHT LEOBEN / FN 294435v		Abteilung / Department B10CERMAT AUSSTELLER / ORIGINATOR / AUTEUR Ackerer DER ABNAHMEBEAUFTRAGTE/ INSPECTOR REPRESENTATIVE/ DU CONTROLLEUR							

7515

We order core & cavity steel from original supplier, and certification of steel and the heat treatment report can be provided.